



**Battery Park  
City Authority**

# **BPC Neighborhood Enhancements**

**CB1 BPC Meeting**

OCTOBER 6, 2025



# Agenda

- Project Overview
- Signage
- Intersection Improvements
- Additional Future Projects
  - North End Avenue Park
  - West St Lighting
  - Murray Street Triangle



# Project Overview

- The **BPC Neighborhood Enhancements** initiative looks to address immediate impacts of the North/West Resiliency Project and demonstrating long-term stewardship of Battery Park City
- Enhancements will keep the neighborhood vibrant and accessible during and after construction, focusing on **wayfinding, intersection safety, lighting, public amenities, plazas, corridor improvements, and public art**

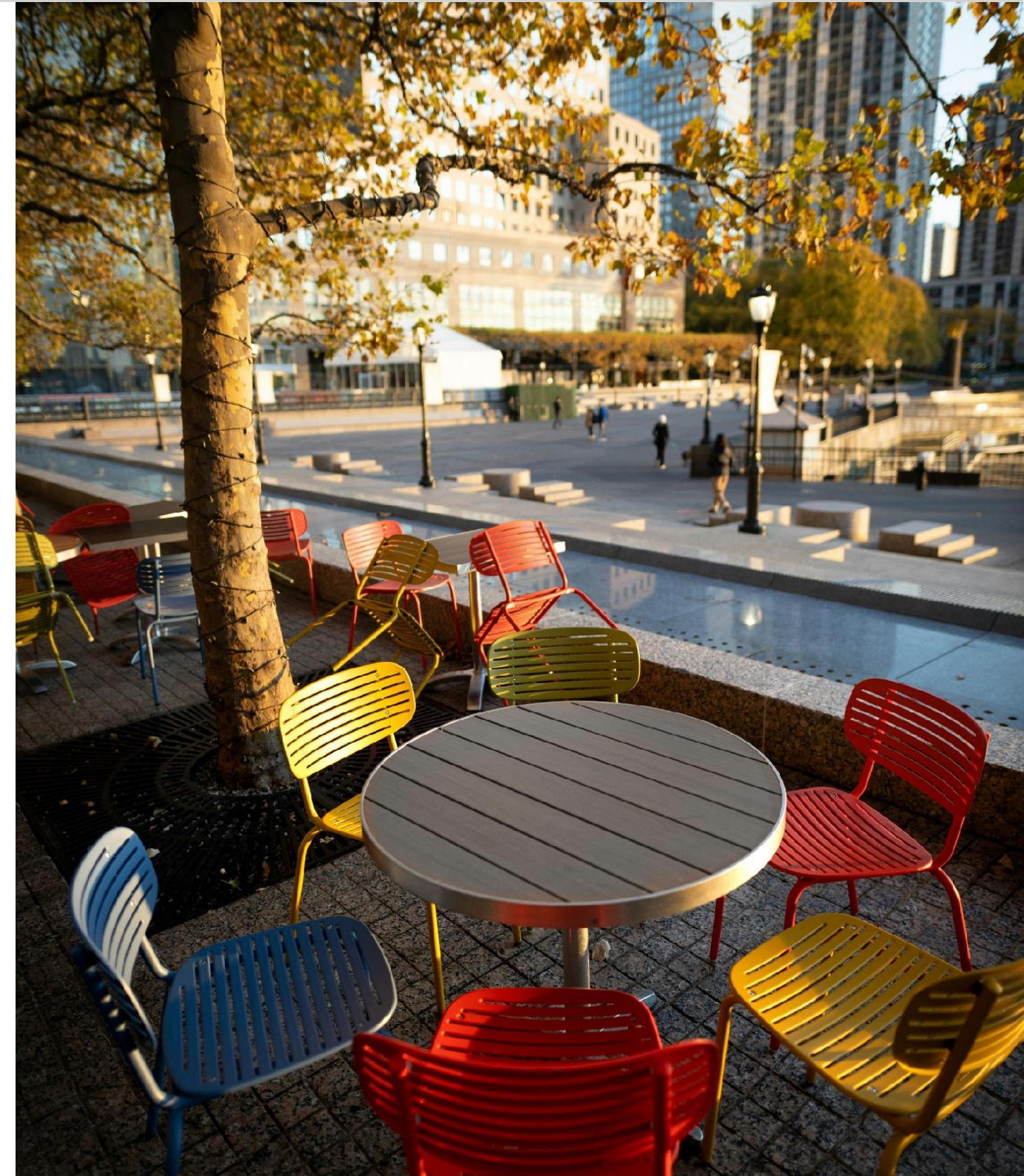

# 1 Signage



# Signage – Temporary Wayfinding/Detour Signage

- Site Readiness Work will be undertaken to prepare sites, reduce risk, and accelerate timelines before the main closures of the Battery Park City Resiliency Project begin
- The project team has developed temporary signs to reroute pedestrians during this work, and share Resiliency Project information



Sign Type A.1



Sign Type A.2



Sign Type A.3



Sign Type A.4



# Signage – Temporary Wayfinding/Detour Signage

- ▶ Temporary Sign
- Site Readiness Work Closure

## Site Readiness - Closure Areas and Temporary Signage



# Signage – Temporary Wayfinding/Detour Signage

## Example Location



# Signage – Semi-Permanent Wayfinding Signage

- Long-term, multi-year closures will support resilience work necessary for making Battery Park City more environmentally resilient
- Semi-permanent signs guide pedestrians, maintain neighborhood vibrancy, and explain the project

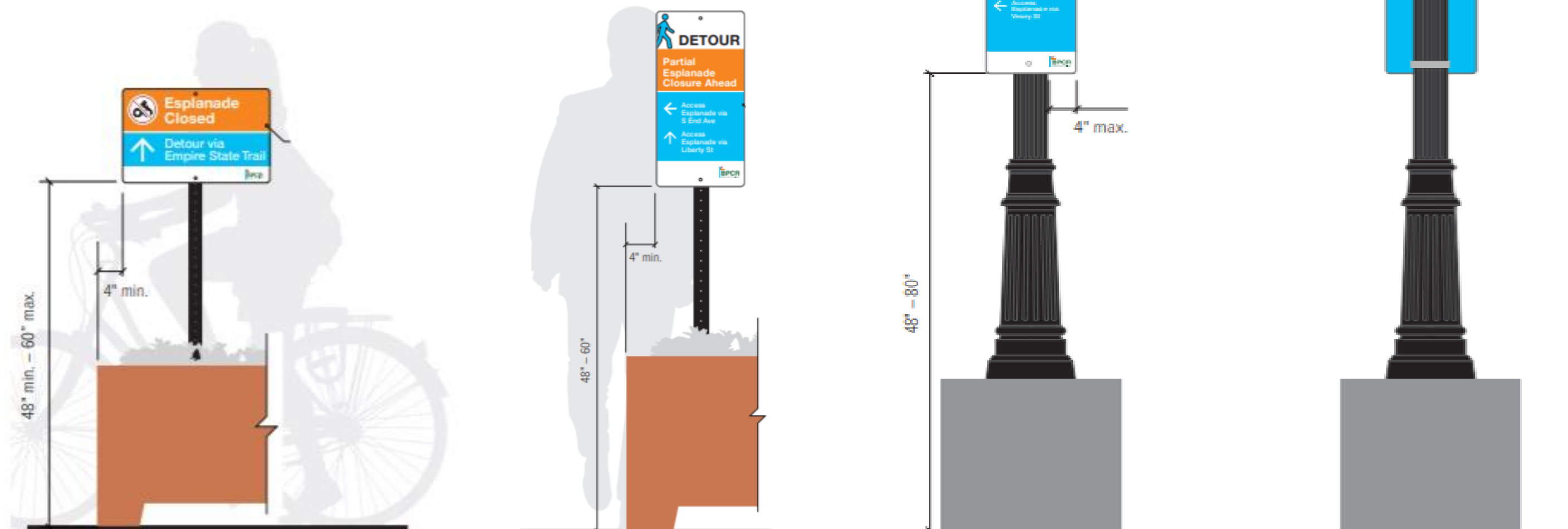

# Signage – Semi-Permanent Wayfinding Signage

## Battery Park City Resiliency Main Closures (First Phase)

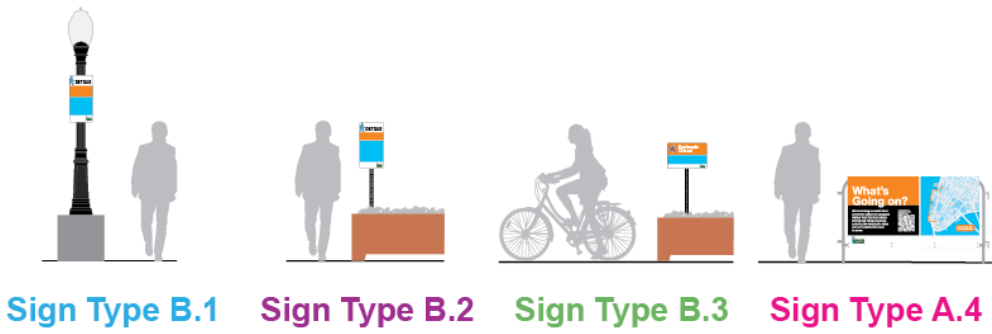

**Legend**

- Jan 2026 Closure
- Mar 2026 Closure
- May 2026 Closure
- Jul 2026 Closure
- Dec 2026 Closure
- Site Readiness Work

- B.1 - Pole Sign
- B.2 - Planter Sign
- B.3 - Cyclist Sign
- A.8 - Barrier Sign



# Signage – Artbridge Art Program

## About Artbridge

- Artbridge is a nonprofit that transforms NYC public spaces into public art exhibitions
- The City Canvas program installs large-scale artworks on temporary fencing, in partnership with NYC agencies such as NYC Department of Buildings and Department of Cultural Affairs
- Program supports emerging artists and brings visual vibrancy to neighborhoods undergoing development
- Each project is tailored to reflect the local community's identity



# Signage – Artbridge Art Program

## Goals of a Large-Scale Construction Fencing Collaboration

- *Battery Park City Vibrancy* - During a time of construction, maintain Battery Park as a vibrant neighborhood for both tourists and locals
- *Community Engagement* - Create and/or select the art with a variety of local stakeholders
- *Resilience Project Awareness* - Build awareness of The Battery Park City Resilience Project, using the art to frame a positive conversation with the surrounding community.



# Signage – Public Art Protection

- Some existing artworks will be protected in place with enhanced plywood barriers
- Enhancements may include images of the artworks and landscape, educational content, materials and history, and QR codes to videos



*Artworks to be protected-in-place*

# Signage – Public Art Protection

## Example of Public Art Protection



Illustration of an enhanced protective barrier concept

# 2 Intersections / Streetscape



# Intersection Improvements (Priority Sites)

BPCA identified priority intersections to improve safety for pedestrians and cyclists through bike boxes, median refuge islands, and curb extensions, alongside other site-specific measures



Bike boxes



Median refuge islands



Curb extensions

- Priority Reviewed Intersections
- Other Reviewed Intersections
- Intersections included in other enhancements



# Intersection Improvements (Example)

## Battery Pl and 3rd Pl

Illustrative treatment showing a representative intersection improvement

### Low-Cost Treatments

Epoxy Gravel



Flexible Delineators



Planters

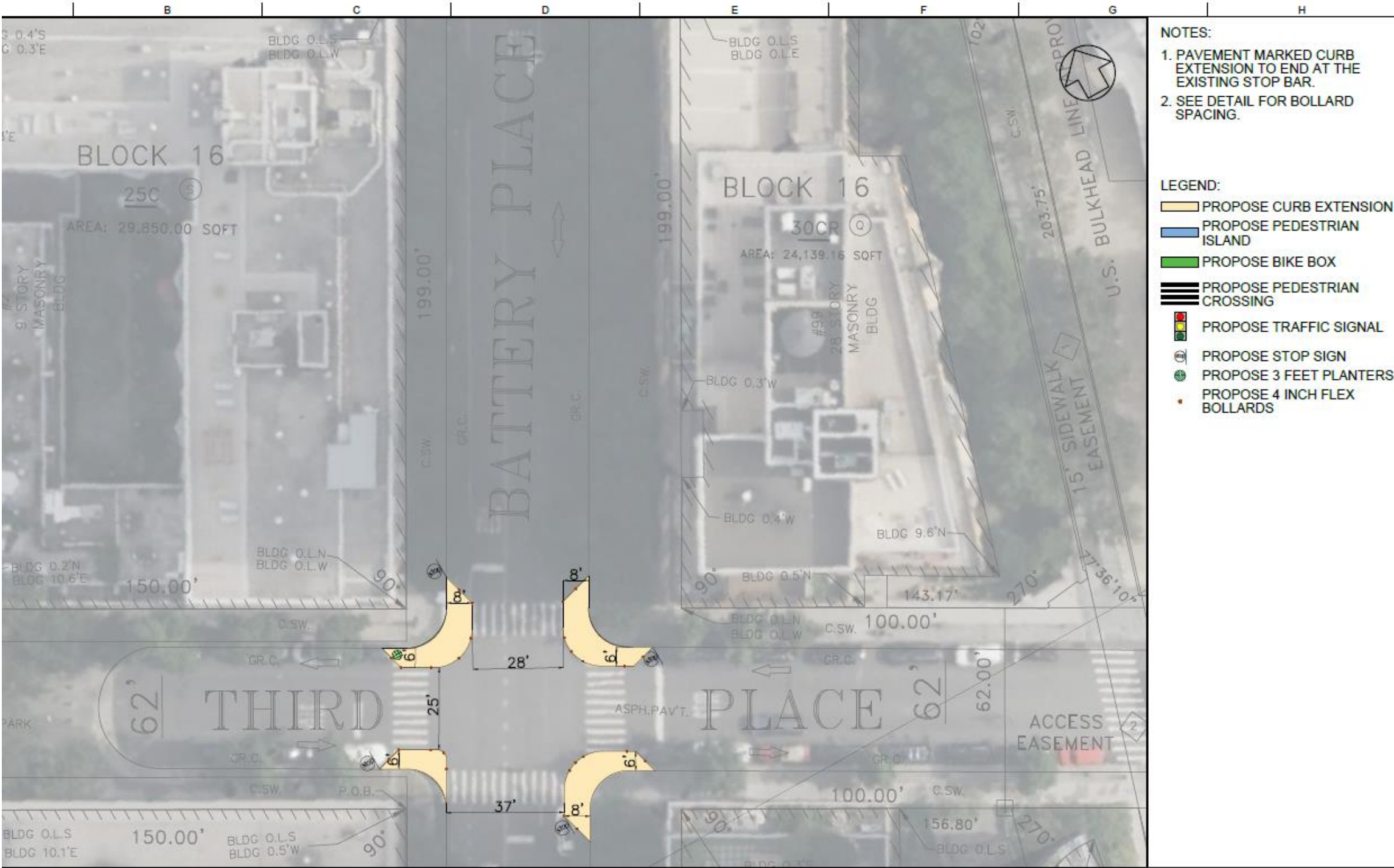

Example of Intersection Improvement at Battery Pl and 3<sup>rd</sup> Pl

# 3

## Future Projects



# North End Avenue Park Enhancements

- BPCA is in the process of concept refinement and stakeholder engagement for this project
- Design process ongoing - continued work with the community, obtain all approvals and permitting.
- BPCA expects to begin implementing enhancements in 2026.



# West Street Lighting Improvements

- BPCA is developing lighting concepts for the pedestrian path along West Street
- Lighting improvements will improve safety, make the space more pleasant for pedestrians, and enhance neighborhood visually
- Project will ensure existing lights are in working order and provide new lighting to enhance pedestrian visibility
- Design process is ongoing, involving ongoing collaboration with the community and securing all necessary approvals and permits.
- BPCA expects to begin implementing enhancements in 2026

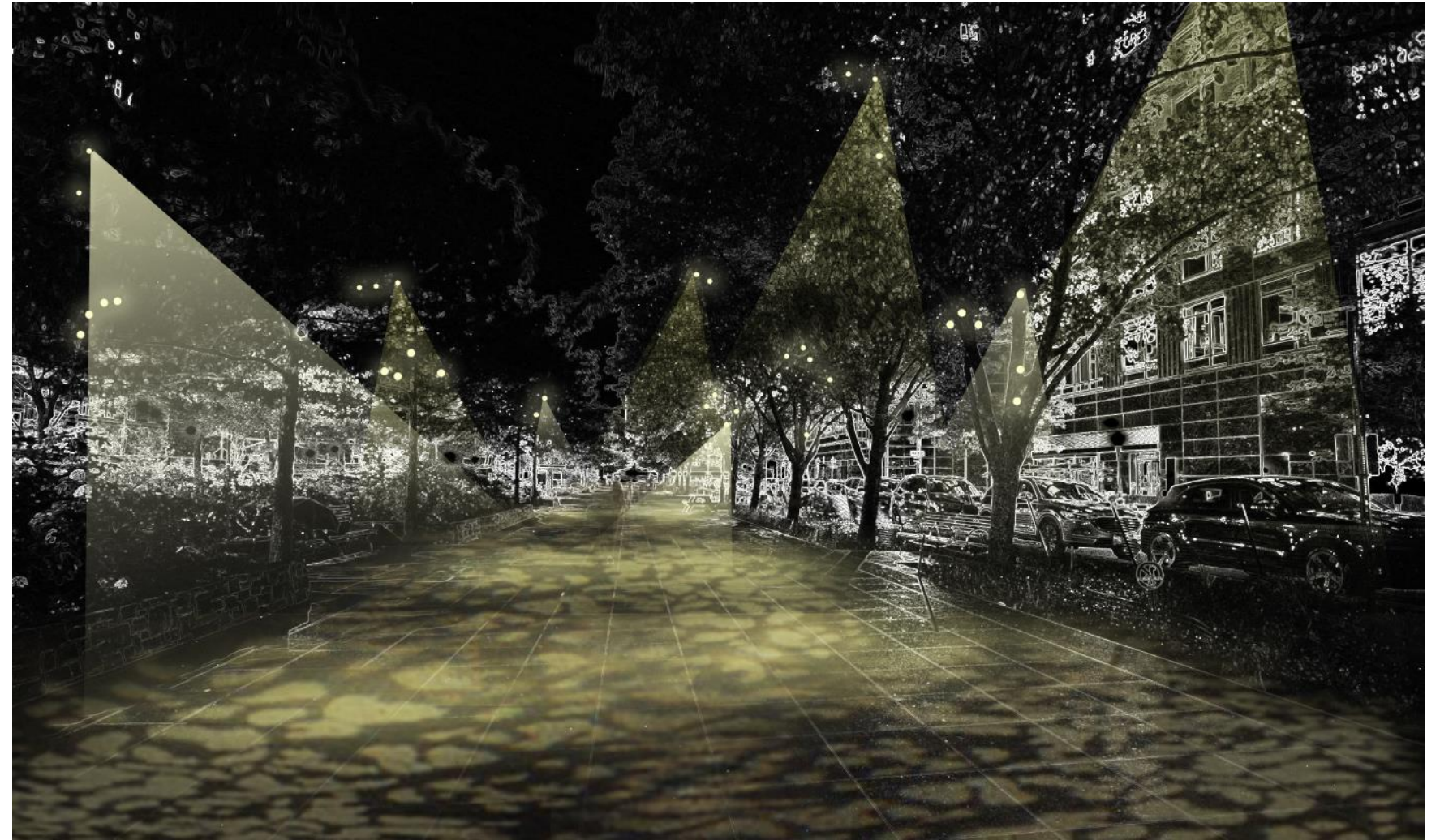

*Illustrative Pedestrian Path Lighting Concept*

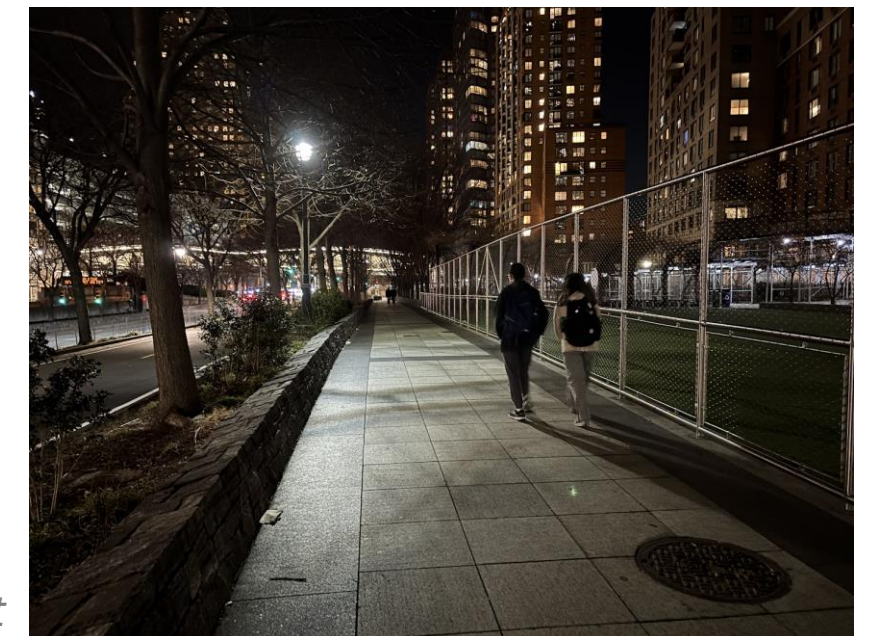

*Existing conditions along West St*

# West Street Lighting Improvements

## Bats

- Light should be minimized, particularly upward tilted light
- Any light should be  $\leq 2700\text{K}$  (ideally 580nm-620nm)
- Light spill-reducing hoods or baffles can be useful
- Reduce harmful blue light

## Birds

- Limited lighting at night is preferred, low intensity to not disturb
- circadian cycles
- Benefit from a high Color Rendering Index (CRI) of 90+, meaning light
- emits a fuller color spectrum to better replicate sunlight

## Insects

- Insects are drawn to blue and white light as well as UV light
- Light around 2700K is ideal to reduce blue spectrums
- Light should not be brighter than necessary

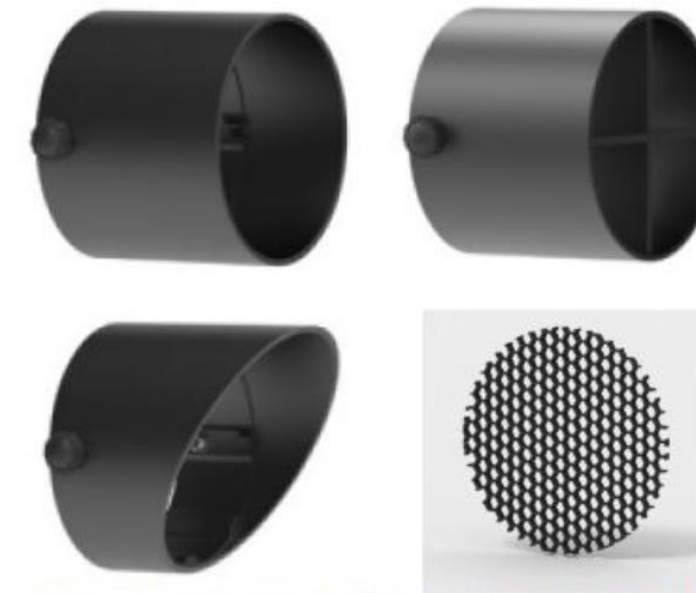

Accessories for luminaires to increase confort, reduce glare

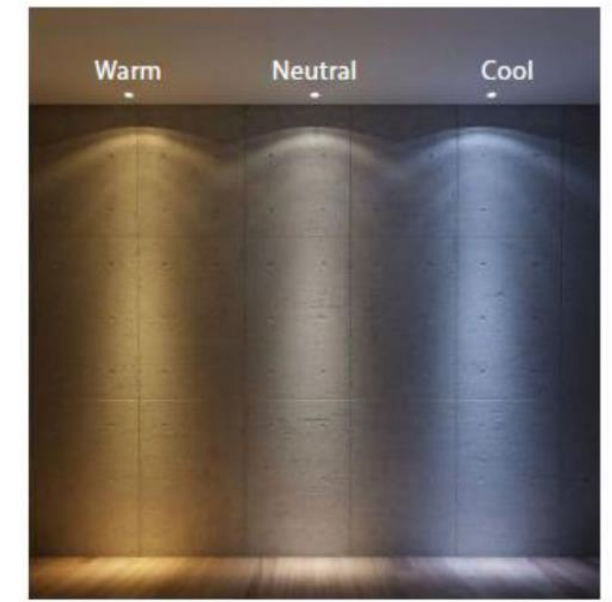

Warmer Color Temperature for Outdoor Lighting

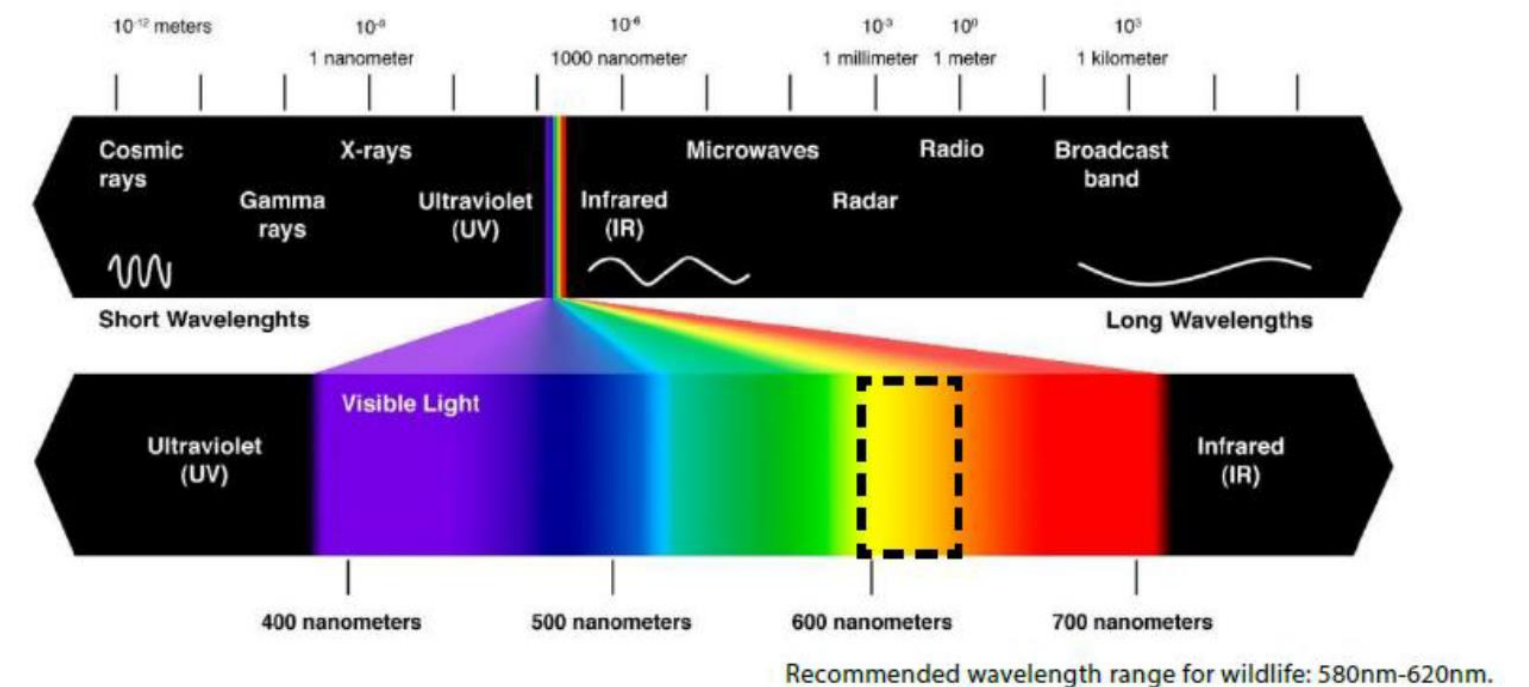

# Murray Street Triangle Enhancement

- BPCA is in the process of concept refinement and stakeholder engagement for this project
- One year design process (2026) to work with the community, obtain all approvals and permitting.
- BPCA does not expect construction to occur until 2027.

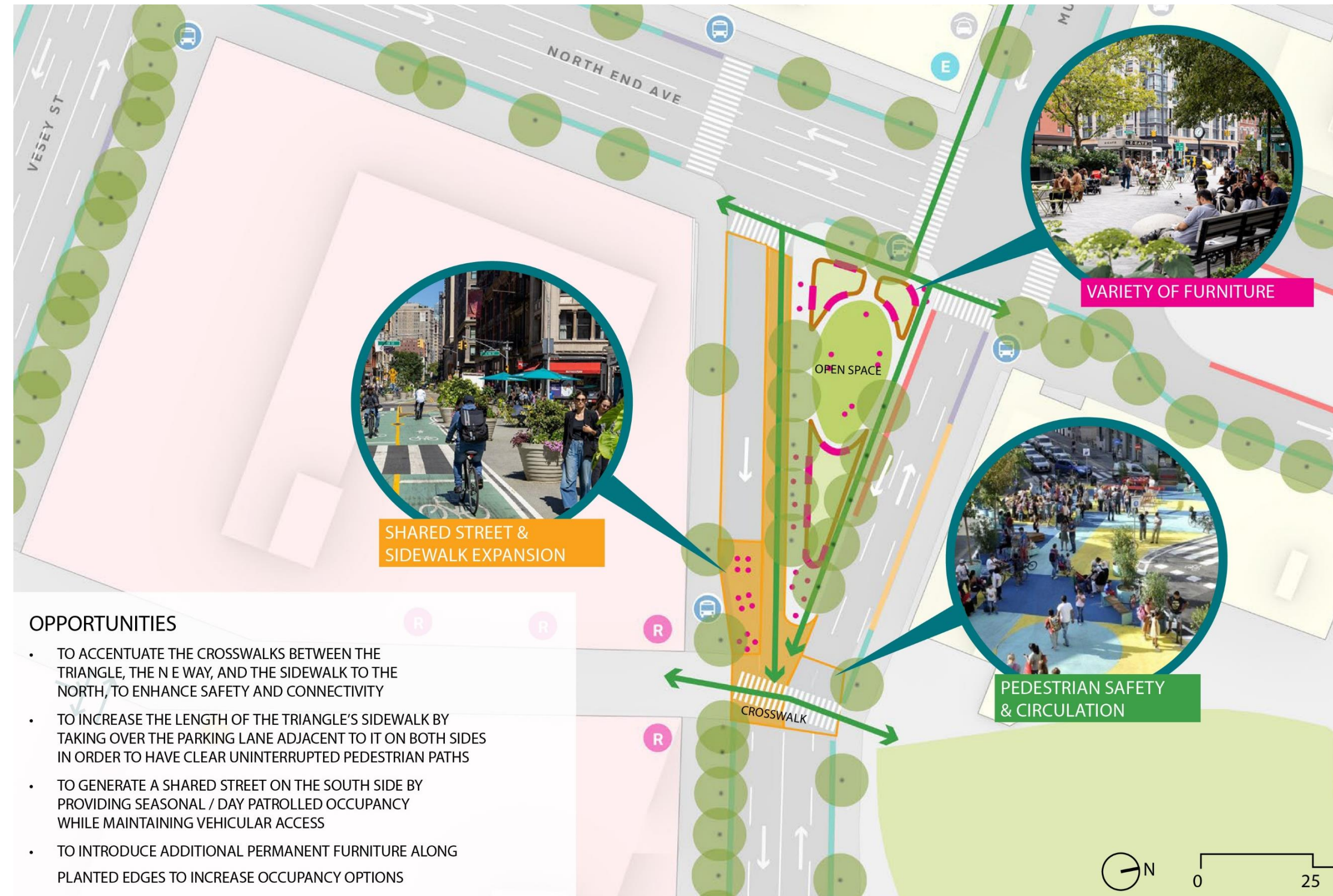

# 4 Next Steps



## Next Steps

- Signage rolled out alongside Site Readiness work.
- Continue work with NYC DOT and NYS DOT on Intersection Improvements
- Advance design efforts and maintain community involvement for upcoming capital projects

# Questions?

